

Application to vary a premises licence under the Licensing Act 2003

PLEASE READ THE FOLLOWING INSTRUCTIONS FIRST

Before completing this form please read the guidance notes at the end of the form. If you are completing this form by hand please write legibly in block capitals. In all cases ensure that your answers are inside the boxes and written in black ink. Use additional sheets if necessary.

You may wish to keep a copy of the completed form for your records.

I/We Rontec Watford Limited

(Insert name(s) of applicant)

being the premises licence holder, apply to vary a premises licence under section 34 of the Licensing Act 2003 for the premises described in Part 1 below

Premises licence number 1

Part 1 – Premises Details

Postal address of premises or, if none, ordnance survey map reference or description Abbey Service Station Avenue Road			
Post town	Torquay	Postcode	TQ2 5LG

Telephone number at premises (if any)	01803 212 671
Non-domestic rateable value of premises	£41,500

Part 2 – Applicant details

Daytime contact telephone number	
E-mail address (optional)	
Current postal address if different from premises address	
Post town	Jersey
	IE1 1BD

Part 3 - Variation

Please tick as appropriate

Do you want the proposed variation to have effect as soon as possible?

Yes

No

If not, from what date do you want the variation to take effect?

DD		MM		YYYY			
┆	┆	┆	┆	┆	┆	┆	┆

Please describe briefly the nature of the proposed variation (Please see guidance note 1)

A petrol forecourt store selling a broad range of groceries, household products and alcohol. Situated at Abbey Service Station, Avenue Road, Torquay, TQ2 5LG to be varied as follows:

1. To extend the hours for the sale of alcohol to 24 hours daily.
2. To include the provision of late night refreshment between the hours of 2300 and 0500 daily.
3. To remove the embedded restrictions in the licence.
4. To include in Annex 2 the conditions in boxes b to e of Section M of the operating schedule.
5. To make alterations to the premises.

If your proposed variation would mean that 5,000 or more people are expected to attend the premises at any one time, please state the number expected to attend:

--

Part 4 Operating Schedule

Please complete those parts of the Operating Schedule below which would be subject to change if this application to vary is successful.

Provision of regulated entertainment

Please tick all that apply

- a) plays (if ticking yes, fill in box A)
- b) films (if ticking yes, fill in box B)
- c) indoor sporting events (if ticking yes, fill in box C)
- d) boxing or wrestling entertainment (if ticking yes, fill in box D)
- e) live music (if ticking yes, fill in box E)
- f) recorded music (if ticking yes, fill in box F)
- g) performances of dance (if ticking yes, fill in box G)
- h) anything of a similar description to that falling within (e), (f) or (g) (if ticking yes, fill in box H)

Provision of late night refreshment (if ticking yes, fill in box I)

Sale by retail of alcohol (if ticking yes, fill in box J)

In all cases complete boxes K, L and M

I

Late night refreshment Standard days and timings (please read guidance note 6)			<u>Will the provision of late night refreshment take place indoors or outdoors or both – please tick</u> (please read guidance note 2)	Indoors	<input type="checkbox"/>			
				Outdoors	<input type="checkbox"/>			
				Both	<input checked="" type="checkbox"/>			
Day	Start	Finish						
Mon	0000	0500	<u>Please give further details here</u> (please read guidance note 3)					
	2300	2400						
Tue	0000	0500						
	2300	2400						
Wed	0000	0500				<u>State any seasonal variations for the provision of late night refreshment</u> (please read guidance note 4)		
	2300	2400						
Thur	0000	0500						
	2300	2400						
Fri	0000	0500	<u>Non standard timings. Where you intend to use the premises for the provision of late night refreshment at different times, to those listed in the column on the left, please list</u> (please read guidance note 5)					
	2300	2400						
Sat	0000	0500						
	2300	2400						
Sun	0000	0500						
	2300	2400						

J

Supply of alcohol Standard days and timings (please read guidance note 6)			Will the supply of alcohol be for consumption – please tick (please read guidance note 7)	On the premises	<input type="checkbox"/>			
				Off the premises	<input checked="" type="checkbox"/>			
				Both	<input type="checkbox"/>			
Day	Start	Finish	State any seasonal variations for the supply of alcohol (please read guidance note 4)					
Mon	0000	2400						
Tue	0000	2400						
Wed	0000	2400						
Thur	0000	2400				Non-standard timings. Where you intend to use the premises for the supply of alcohol at different times to those listed in the column on the left, please list (please read guidance note 5)		
Fri	0000	2400						
Sat	0000	2400						
Sun	0000	2400						

K

Please highlight any adult entertainment or services, activities, other entertainment or matters ancillary to the use of the premises that may give rise to concern in respect of children (please read guidance note 8).

The premises sell alcohol and other age restricted products.

L

Hours premises are open to the public Standard days and timings (please read guidance note 6)			State any seasonal variations (please read guidance note 4)
Day	Start	Finish	
Mon	0000	2400	
Tue	0000	2400	
Wed	0000	2400	
Thur	0000	2400	
Fri	0000	2400	
Sat	0000	2400	
Sun	0000	2400	
			Non standard timings. Where you intend the premises to be open to the public at different times from those listed in the column on the left, please list (please read guidance note 5)

Please identify those conditions currently imposed on the licence which you believe could be removed as a consequence of the proposed variation you are seeking.

- The embedded restrictions set out in the licence.
- The hours for the sale of alcohol are currently restricted to:
 - Monday to Saturday (other than Christmas Day): 0800 to 2300
 - Sunday (other than Christmas Day) 1000 to 2230
 - Good Friday 0800 to 2230
 - Christmas Day 1200 to 1500 and 1900 to 2230.

The above restrictions and conditions would be removed as a consequence of the proposed variation.

Please tick as appropriate

a) General – all four licensing objectives (b, c, d and e) (please read guidance note 9)

b) The prevention of crime and disorder

1. A CCTV system will be installed, or the existing system maintained, such system to be fit for the purpose.
2. The CCTV system shall be capable of producing immediate copies of recordings on site. Copies of recordings will be capable of being recorded digitally on to CD/DVD or other equivalent medium.
3. Any recording shall be retained and stored in a suitable and secure manner for a minimum of 28 days and shall be made available, subject to compliance with Data Protection legislation, to the police for inspection on request.
4. The CCTV system will incorporate a camera covering the entrance door and the alcohol display areas and will be capable of providing an image which is regarded as identification standard. The precise positions of the cameras may be agreed, subject to compliance with Data Protection legislation, with the police from time to time.
5. The system will display, on any recording, the correct time and date of the recording.
6. A system will be in place to maintain the quality of the recorded image.
7. The CCTV system will be maintained so as to be fully operational throughout the hours that the premises are open for any licensable activity.

c) Public safety

The premises licence holder will at all times maintain adequate levels of staff. Such staff levels will be disclosed, on request, to the licensing authority and police.

d) The prevention of public nuisance

Adequate waste receptacles for use by customers shall be provided in and immediately outside the premises.

e) The protection of children from harm

The premises licence holder will ensure that an age verification policy will apply to the premises whereby all cashiers will be trained to ask any customer attempting to purchase alcohol, who appears to be under the age of 25 years (or older if the licence holder so elects) to produce, before being sold alcohol, identification being a passport or photocard driving licence bearing a holographic mark or other form of identification bearing the customer's photograph, date of birth and the Proof of Age Standards Scheme (or similarly accredited scheme) hologram.

Checklist:

Please tick to indicate agreement

- I have made or enclosed payment of the fee.
- I have sent copies of this application and the plan to responsible authorities and others where applicable.
- I understand that I must now advertise my application.
- I have enclosed the premises licence or relevant part of it or explanation.
- I understand that if I do not comply with the above requirements my application will be rejected.

IT IS AN OFFENCE, LIABLE ON SUMMARY CONVICTION TO A FINE NOT EXCEEDING LEVEL 5 ON THE STANDARD SCALE, UNDER SECTION 158 OF THE LICENSING ACT 2003, TO MAKE A FALSE STATEMENT IN OR IN CONNECTION WITH THIS APPLICATION.

Part 5 – Signatures (please read guidance note 10)

Signature of applicant (the current premises licence holder) or applicant's solicitor or other duly authorised agent (please read guidance note 11). If signing on behalf of the applicant, please state in what capacity.

Signature	<i>W. Wood CP</i>
Date	23 June 2014
Capacity	Solicitors duly authorised on behalf of the Applicant

Where the premises licence is jointly held, signature of 2nd applicant (the current premises licence holder) or 2nd applicant's solicitor or other authorised agent (please read guidance note 12). If signing on behalf of the applicant, please state in what capacity.

Signature	
Date	
Capacity	

THE ENTIRE PREMISES MAY BE USED FOR
THE SALE OF ALCOHOL AND THE PROVISION
OF LATE NIGHT REFRESHMENT

ABBEY - PROPOSED

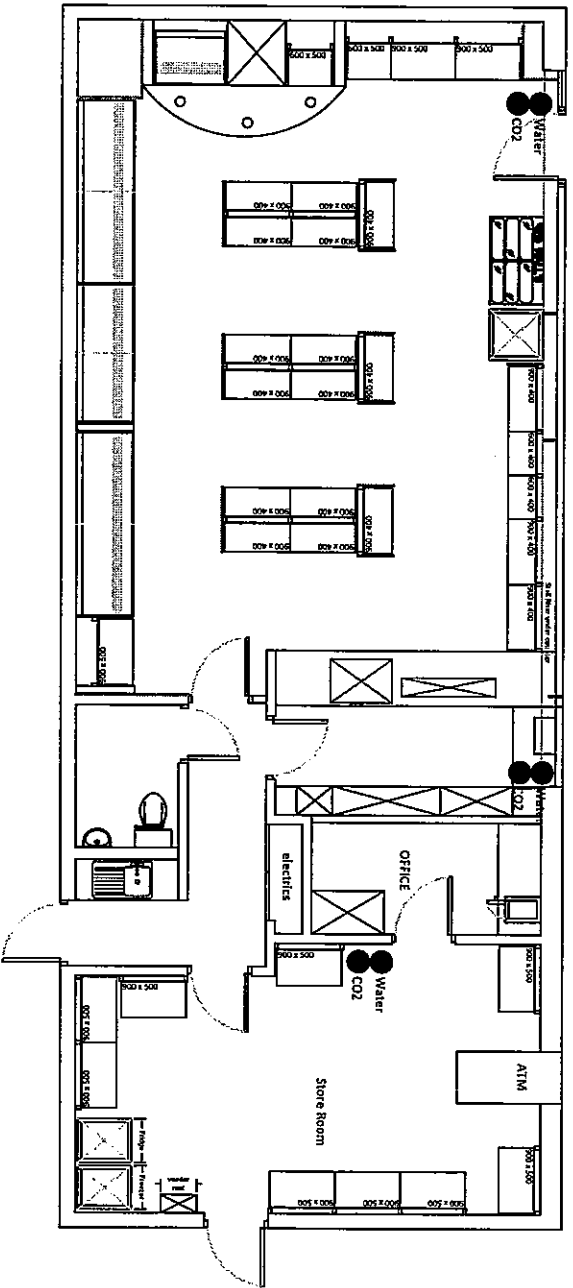

Client: Main Premises/Proposed/Abbey/2014

NO.	REVISION	DATE
1	ISSUED FOR TENDERS	15/03/14

Atlas Shopping Design
& Project Management
21 Widdowhatch Lane
Long Benington
Newark
Nottinghamshire
NG24 0JH
0115 937 7259
sales@atlasshoppingdesign.com
website: www.atlasshoppingdesign.co.uk

Client:	Remite
Address:	Abbey Forest TON11D
Drawing Title:	02 Licence Drawings
Customer Approval:	Date:
Scale:	1:1000
Drawn by:	DA-1013

These drawings are the property of Atlas Shopping Design & Project Management. They are not to be used for any other purpose without the written consent of Atlas Shopping Design & Project Management.